

Land Pattern Recommendation

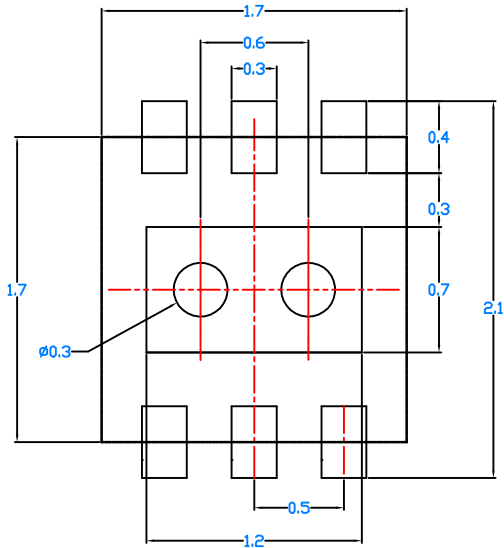

NOTES:

1.All dimensions are in millimeters.

Exposed Pad Size: 1.2x0.7mm	Remarks:
PIN Pitch: 0.5mm	Date: 2021/10/18
Number of Via: 2	Title: BSW-1.7x1.7-6L-LP211018
Via diameter: 0.3mm	Version: Rev1.0
Exposed Pad via pitch: 0.6mm	

BeRex Confidential

